

 Floor Tile

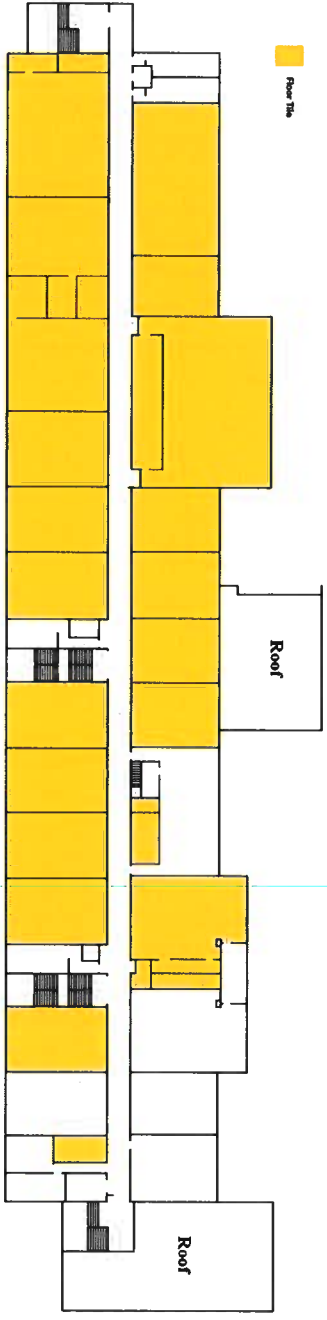

Entrance

**Dwight Eisenhower
First Floor**



**Dwight Eisenhower
Second Floor**

GYMNASIUM - 988
 CAFETERIUM - 784
 TOTAL SQ. FT. - 139,951

DWIGHT D. EISENHOWER MIDDLE
 FIRST FLOOR

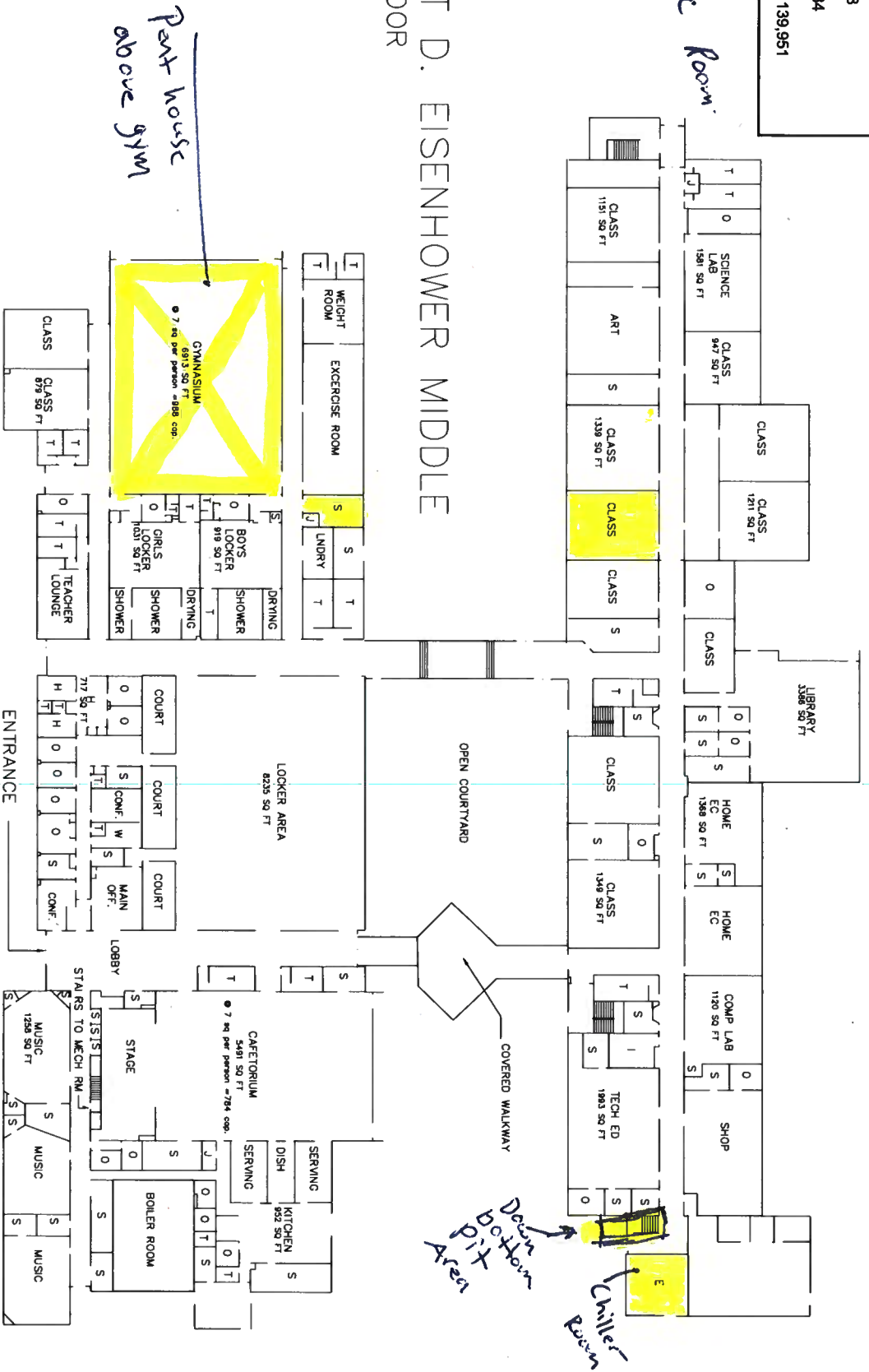

PRINCE GEORGE'S COUNTY
 PUBLIC SCHOOLS



DEPARTMENT OF PLANNING
 AND ARCHITECTURAL SERVICES



Paul L. Taylor Jr., Director
 13300 OLD MARLBORO PIKE
 UPPER MARLBORO, MARYLAND 20772

PROJECT DWIGHT D. EISENHOWER MIDDLE SCHOOL
 13725 BRIARWOOD DRIVE, LAUREL, MD

TITLE BUILDING CAPACITY

DATE 12/9/2008

PROJ. NO.

DRAWN BY TW & PLD

SCALE: NONE

DWG. NO.: 1 OF 2



Mechanic Room
T S I

DWIGHT D. EISENHOWER MIDDLE
SECOND FLOOR

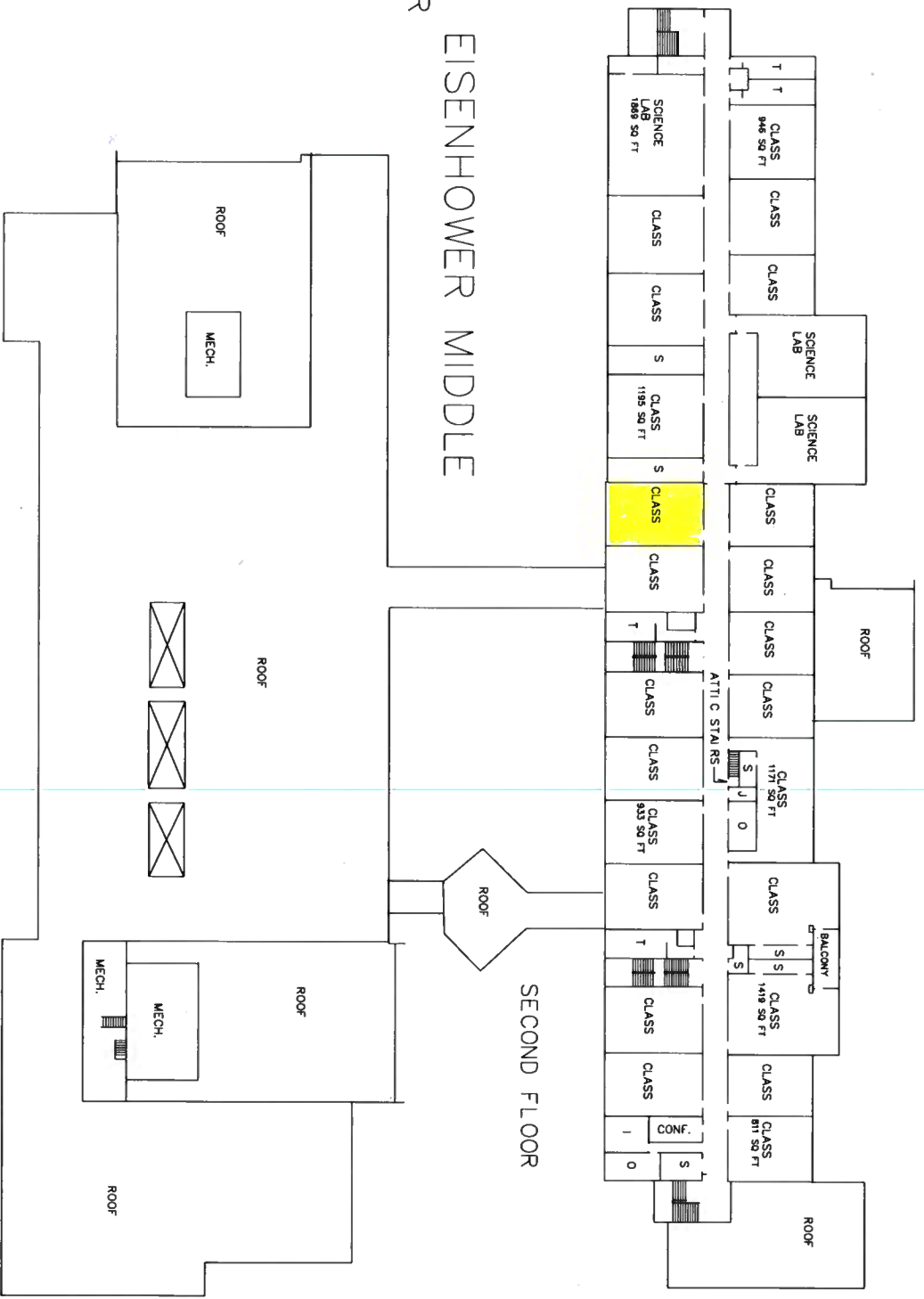

PRINCE GEORGE'S COUNTY
PUBLIC SCHOOLS
DEPARTMENT OF PLANNING
AND ARCHITECTURAL SERVICES
Paul L. Taylor, Jr., Director
13300 OLD MARLBORO PIKE
UPPER MARLBORO, MARYLAND 20772

PROJECT
DWIGHT D. EISENHOWER MIDDLE SCHOOL
13725 BRIARWOOD DRIVE, LAUREL, MD

TITLE
BUILDING CAPACITY

| | |
|-----------|-----------|
| DATE | 12/9/2008 |
| PROJ. NO. | |
| DRAWN BY | TW & PLD |
| SCALE: | NONE |
| DWG. NO.: | 2 OF 2 |

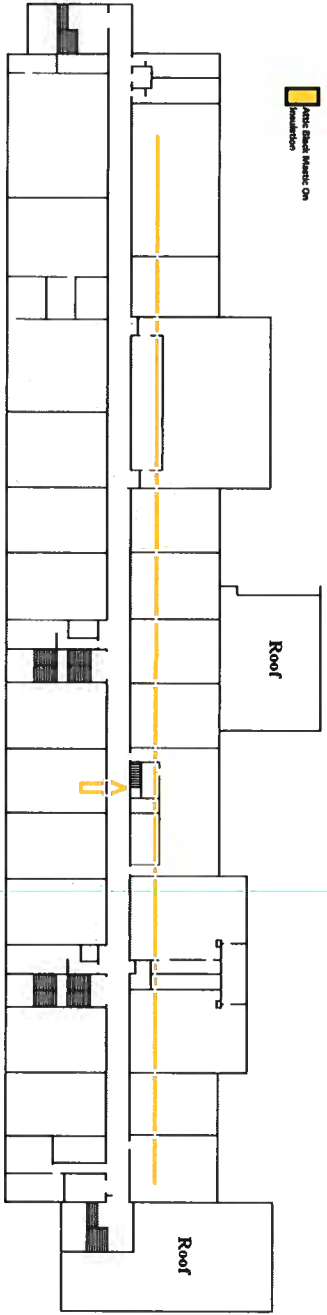

**Dwight Eisenhower
Second Floor**

Pipe Covering

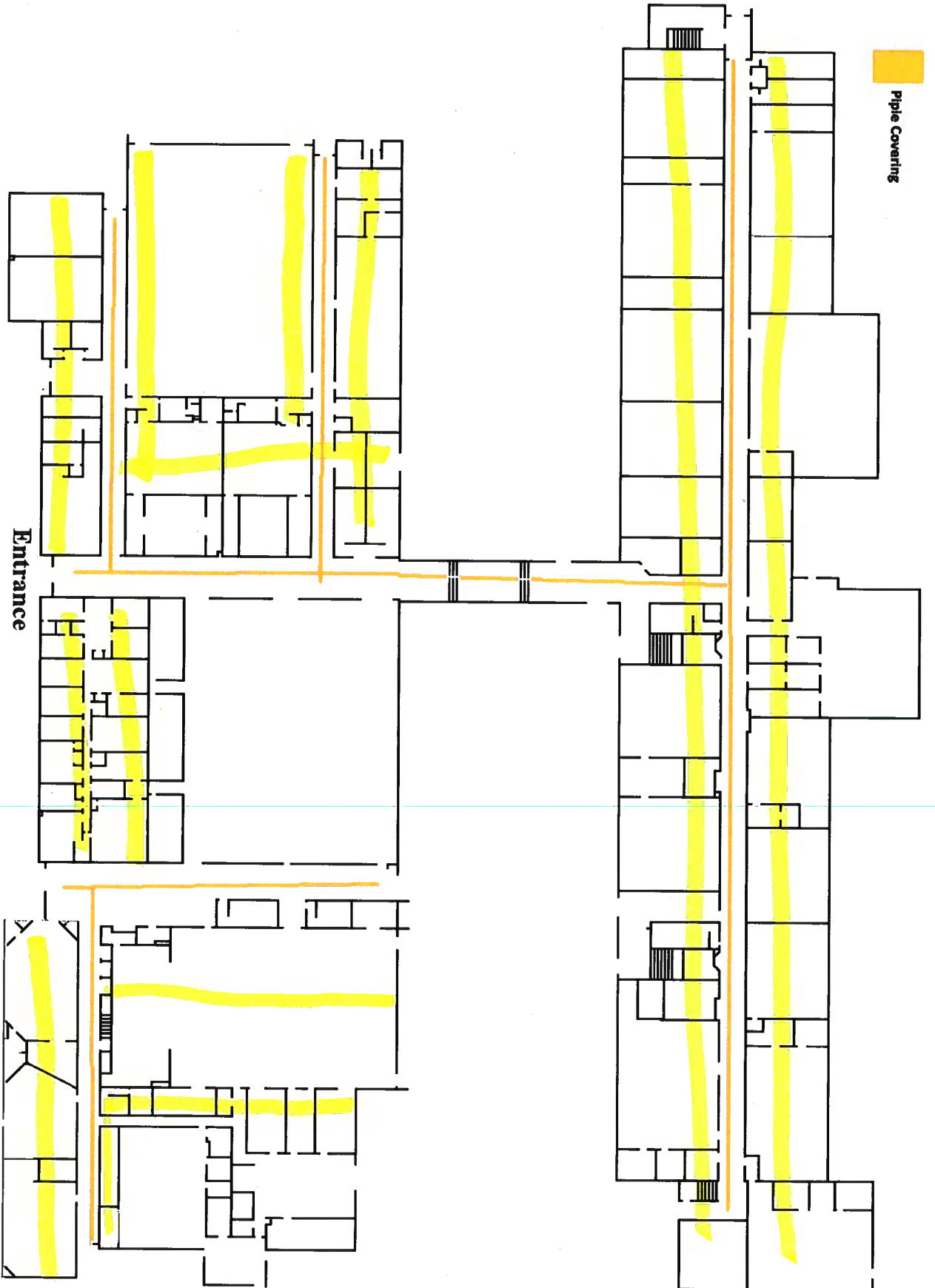

Dwight Eisenhower
First Floor

Pipe Ins

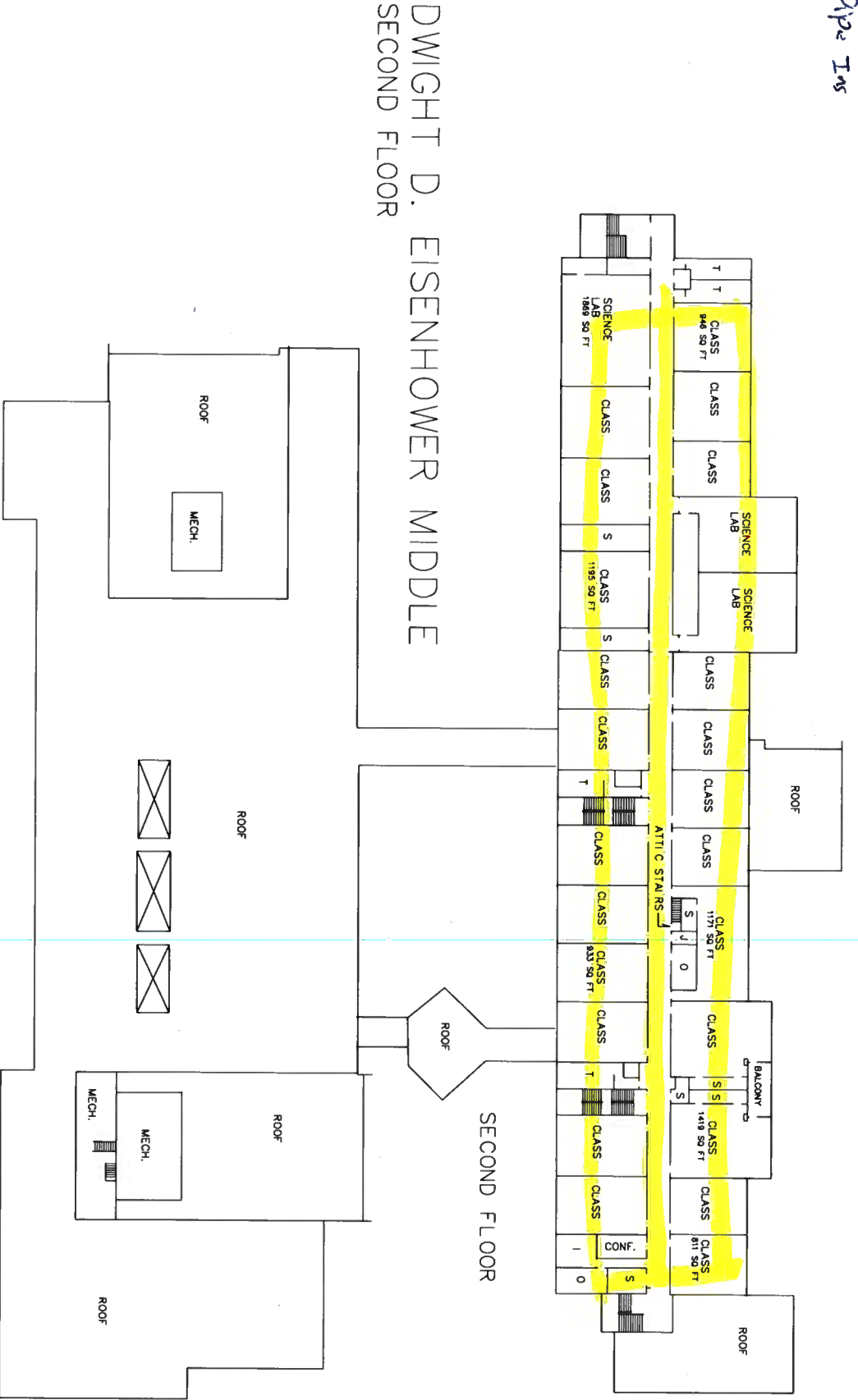

DWIGHT D. EISENHOWER MIDDLE
SECOND FLOOR



PRINCE GEORGE'S COUNTY
PUBLIC SCHOOLS
DEPARTMENT OF PLANNING
AND ARCHITECTURAL SERVICES
Paul L. Taylor Jr., Director
13300 OLD MARLBORO PIKE
UPPER MARLBORO, MARYLAND 20772



| | | | | |
|---------|---|--|-----------|-----------|
| PROJECT | DWIGHT D. EISENHOWER MIDDLE SCHOOL | | DATE | 12/9/2008 |
| TITLE | 13725 BRIARWOOD DRIVE, LAUREL, MD | | PROJ. NO. | |
| | BUILDING CAPACITY | | DRAWN BY | TW & PLD |
| | | | SCALE: | NONE |
| | | | DWG. NO.: | 2 OF 2 |